

Jefferson Townlake

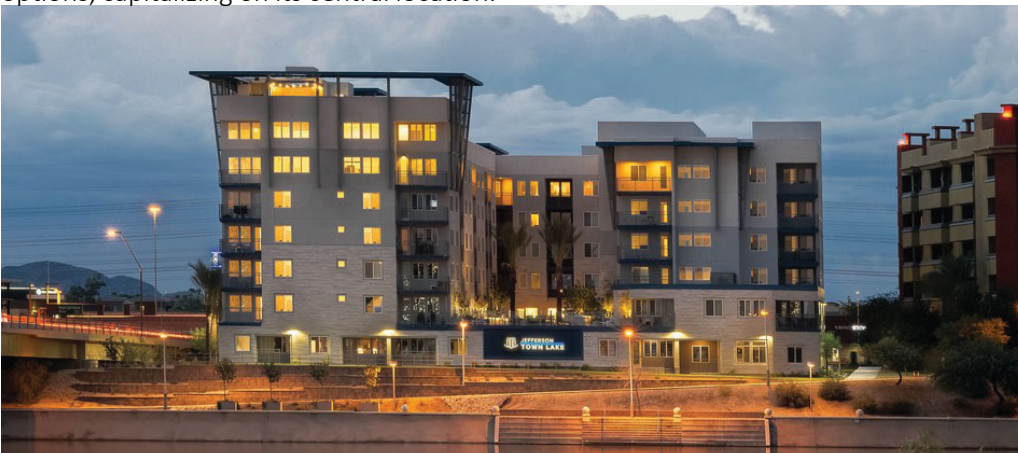

Jefferson Town Lake is located in Tempe, Arizona, overlooking the iconic Tempe Town Lake. This desirable location sits at the entry to a City, a University, a large employer base, and a lake full of outdoor activities. The site size, shape and utility constraints made for a challenge, but the end result is a 244-unit multi-family community, on a 1.5 acre lot.

This 7 story building has a base of stone veneer, transitioning to a softer grey above, accenting the balconies and window coloration. Upper levels, at the roof-top deck, show off the metal roof and supports against the desert sky. The development includes dwelling units with direct access to the lake. Amenities include a vanishing edge pool, a resort style spa area, outdoor kitchen and a community lounge. The unique fitness studio has both indoor and outdoor options, capitalizing on its central location.



Client:

TDI Lifestyle Residential Communities

Contractor:

JPI Companies

Location:

Tempe, AZ

Design Team:

Architecture:
ORB Architecture, LLC

Landscape:
Collaborative V

Structural Engineering:
Caruso Turley & Scott, Inc.

Mechanical Engineering:
NP Mechanical

Electrical Engineering:
NP Engineering

Civil Engineering:
Kland Civil Engineers

Energy Consultant:
Quest Energy Group

Size:

1.5 Acres

244 Units

Services:

Design

Zoning

Municipal Design Review Processing

Design Documents

Construction Documents

Construction Administration

Amenities:

Below Grade Parking

Indoor/Outdoor Fitness Studio

Luxury Style Pool & Spa

Roof Deck

Outdoor Kitchen & Game Room

Outdoor Grill Areas

Water Craft Storage

Wine Storage

