

Aura Apache



Aura Apache is located along Apache Boulevard, in Tempe Arizona, opposite the light rail “Park and Ride” lot.

The mixed-use project incorporates co-work space, and residential units at street-level along Apache Boulevard, combined with a vibrant street-front design that includes shaded seating, bringing a pedestrian-friendly environment to the streetscape.

The design is attractive and modern, thoughtfully engaging the surrounding community. While the design reflects the modern aesthetic of other buildings along Apache Boulevard, it also respects the local neighborhood. The design caters to pedestrians through the use of building character, connectivity, landscaping, hardscape, lighting, and signage.

The resident’s six-story parking structure is

wrapped by buildings; secured, and screened from street view. Parking for prospective residents, the commercial/co-work space, and rideshare/deliveries are conveniently located within the parking courtyard on the project’s entry drive.

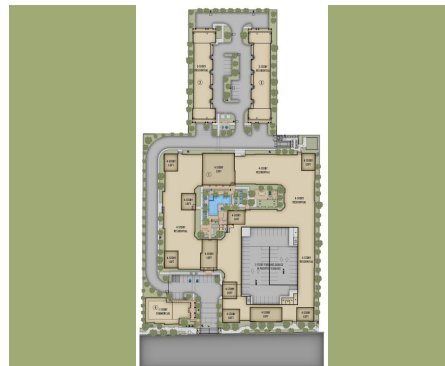

Client:

Trinsic Residential Group

Contractor:

Trinsic Residential Builders

Location:

Tempe, AZ

Design Team:

Architecture:
ORB Architecture, LLC

Landscape:
Collaborative V Design Studio, Inc.

Structural Engineering:
Landa & Associates, Inc.

Mechanical Engineering:
NP Mechanical

Electrical Engineering:
Hawkins Design Group, Inc.

Civil Engineering:
Hubbard Engineering

Interior Design:
Inspire Studios, LLC

Size:
4.94 Acres
298 Units

Services:

Preliminary Site Plan
Entitlements
Design Development
Construction Documents
Construction Administration

Amenities:

Resort Style Pool & Spa
Fitness Center
Recreation Clubhouse
Dog Park
Co-Work Office Space
Rideshare / Transit Hub

